



Spring Road
Bournemouth
Dorset
BH1 4PZ

£275,000

A MODERN TWO DOUBLE BEDROOM END OF TERRACE
HOUSE WITH PRIVATE REAR GARDEN AND ALLOCATED
OFF ROAD PARKING.

ALBURY
& HALL



Situated in a popular suburb of Bournemouth, this modern end of terrace property presents an ideal opportunity for a first time buyer or buy to let investor.

- ◆ End of Terrace House
- ◆ Two Double Bedrooms
- ◆ Ground Floor Cloakroom
- ◆ First Floor Family Bathroom
- ◆ Private Rear Garden
- ◆ Allocated Off Road Parking
- ◆ Ideal First Time Buy or Buy to Let
- ◆ No Forward Chain
- ◆ Short Walk to Local Shops & Facilities
- ◆ Close to Bournemouth Town Centre & Beach



Entrance Hall

Upon entering the property, you are welcomed by a bright entrance hall with doors to all of the ground floor accommodation and stairs to the first floor landing. There is also a handy understairs storage cupboard.

Lounge/Dining Room

This spacious room to the rear aspect of the property benefits from double doors providing direct access to the private rear garden. There is ample space for a sizeable sofa as well as a dining table and other furniture.

Kitchen

This modern fitted kitchen has a range of base and eye level units, a built in electric oven with gas hob over, inset stainless steel sink and drainer with mixer tap over and under counter space for appliances. A cupboard houses the gas boiler.

Outside

The property benefits from an easily maintained private rear garden and an allocated off road parking space to the rear. A driveway from Spring Road leads through to the rear of the terrace of houses.



Bedroom One

This good-sized double bedroom is positioned to the rear of the property and benefits from neutral décor and ample space for furniture.

Bedroom Two

Also a spacious double bedroom to the front of the property and with neutral décor, this bedroom benefits from a built in storage cupboard.

Family Bathroom

The family bathroom has part tiled walls and comprises a bath with wall-mounted shower over, push button W.C. and pedestal sink.



ALBURY & HALL

GROUND FLOOR

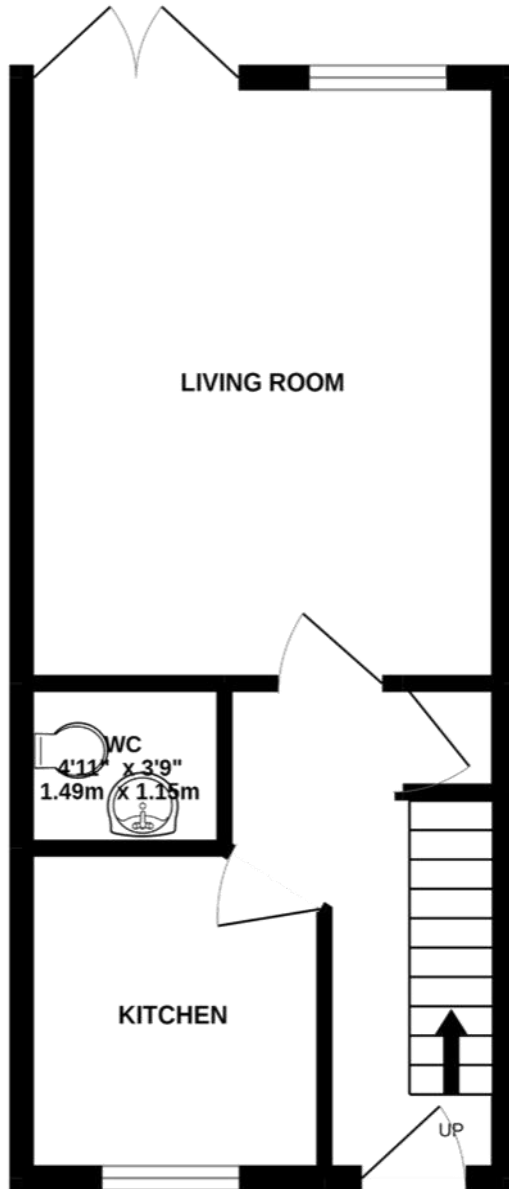

1ST FLOOR

